



Charge-M8[®] Omega

60kW DC EV Charger



High Efficiency

Advanced soft-switching design for stable, efficient performance.



Easy Operation

7-inch touch screen with clear status indicators.



Full Protection

Comprehensive electrical and thermal protection.



Smart Charging

EVSCP compliant



All-Weather Use

IP55 and -30°C to +55°C operation.



OCPP 1.6

Background communication protocol enables platform connectivity.



Network

Built-in 4G, RJ45 Ethernet and Wi-Fi (2.4 GHz)



+44 3332423328



sales@charge-m8.com



www.charge-m8.com

Charge-M8 Omega 60kW DC Charger

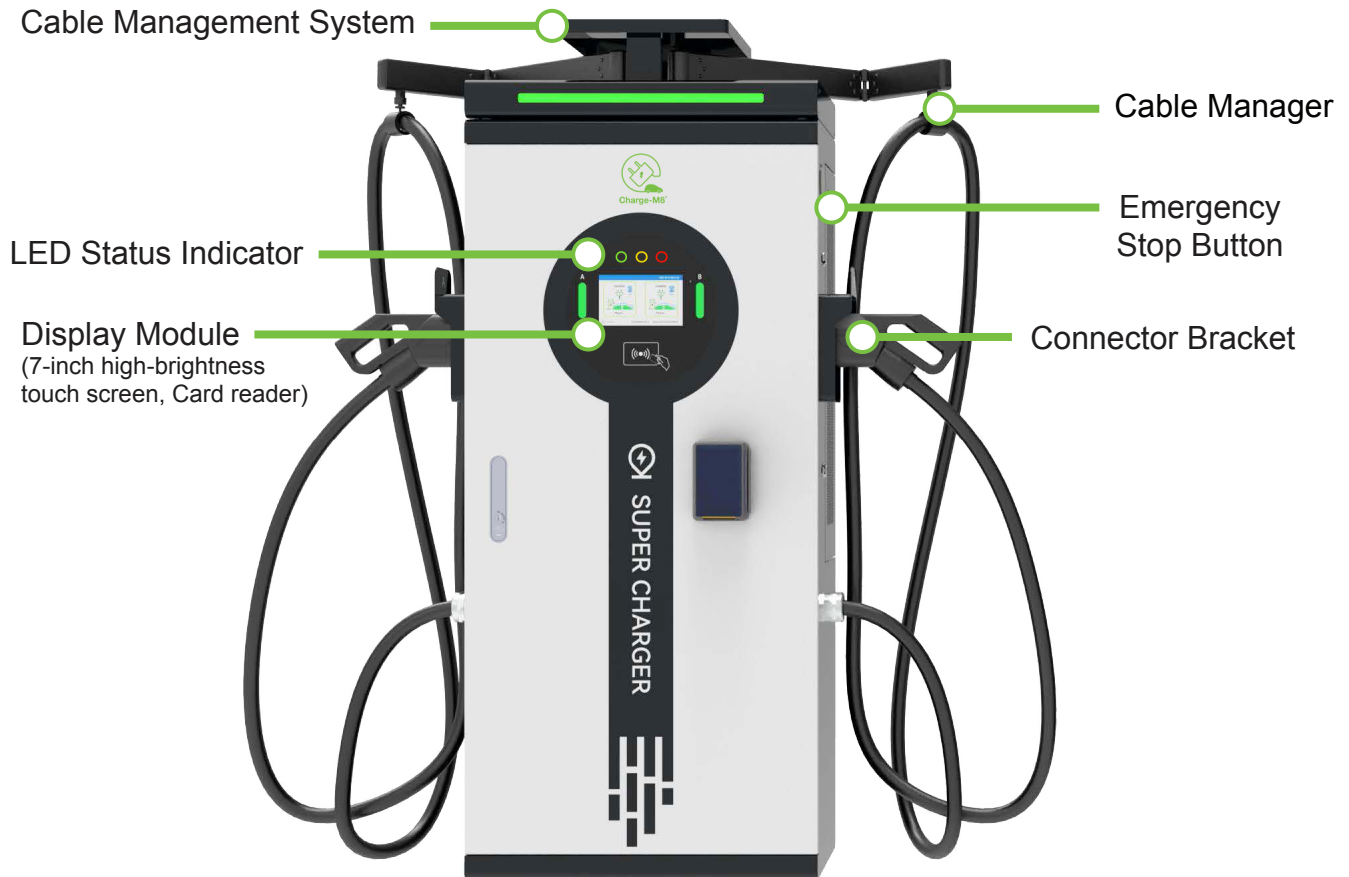

Key Strengths



The Omega DC charger provides safe and reliable charging for electric vehicles with the CCS2 standard connector socket.



Built-in 4G
Wi-Fi (2.4 GHz)
RJ45 Ethernet



Background communication protocol OCPP1.6 enables platform connectivity.

Fast. Safe. Efficient.

The Omega DC charger provides safe and reliable charging for electric vehicles equipped with the CCS2 standard connector. The charger communicates with the vehicle battery management system (BMS) in real time during the charging process to ensure smart and safe vehicle charging.

Example installation scenarios include:

- Electric vehicle transport depots (Bus/Truck);
- Hospitality (Hotels and sports clubs);
- Commercial business offices;
- Car dealerships;
- Public EV charging sites.

Product Features

- Omega chargers incorporate advanced soft-switching technology, delivering high conversion efficiency and stable performance, whilst their modular design allows for convenient operation and maintenance.
- The Omega core features include a signal indicator LED, touch screen user interface, RFID module (swipe card), metering module (electricity meter), OCPP control unit, power conversion module, charging controller, charging connector, emergency stop button, and multiple protection modules

Internal Key Modules



LED status indicator



Touch screen user interface



RFID card module



Metering module



Billing control unit



Power conversion module



Charging controller



Charging connector



Emergency stop button



Protection module

Charge-M8 Omega Dimension Drawing

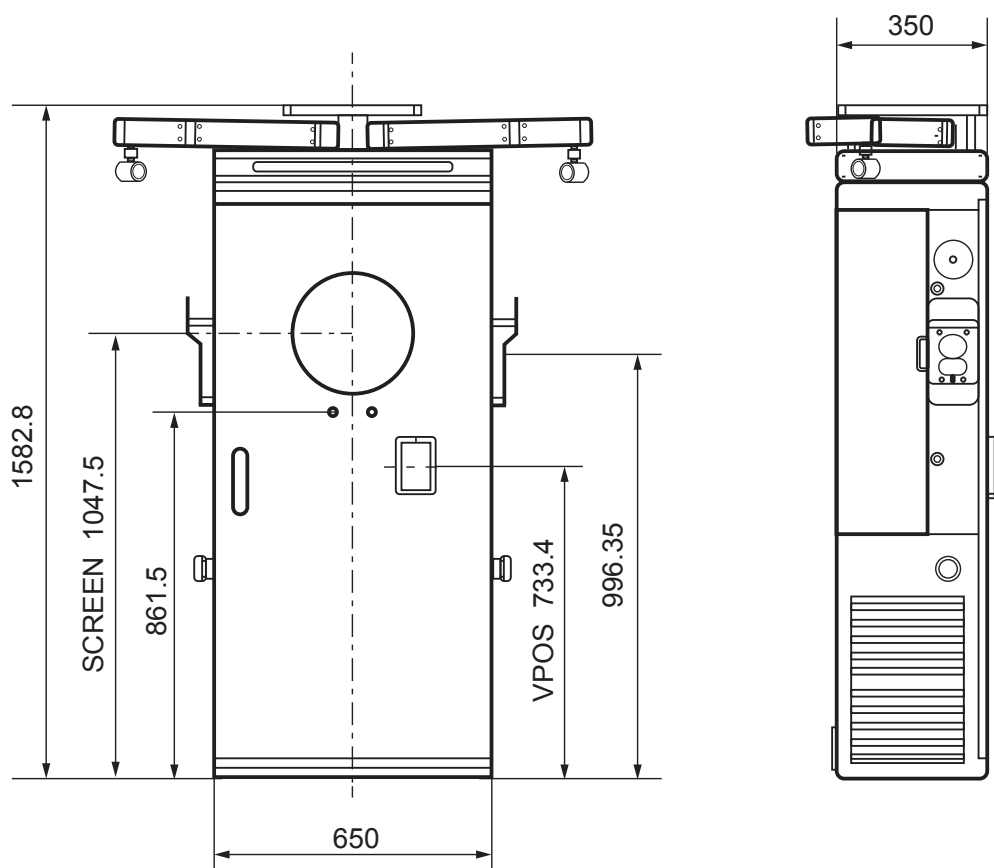

Unit: mm

Technical Specifications

Power rating	60 kW
Input voltage	400 \pm 10 percent V AC
Output voltage	200 to 1000 V DC
Maximum output current	2 \times 100A
Peak efficiency	\geq 96 percent
Power factor	\geq 0.99
Protection level	IP55
Operating temperature	-30°C to +55°C

Compatibility

- CCS2 connector based on IEC 62196-3:2022
- Charging communication protocol DIN 70121 and ISO 15118
- Background communication protocol OCPP 1.6
- Electromagnetic compatibility IEC 61851-21-2
- Safety standards EN 61851-23 and EN 61851-1
- Cooling method forced air cooling

Product Warranty

Warranty Period

Charge-M8 provides a 3-year warranty against manufacturing defects from the date of purchase, conditional upon the installation and annual servicing requirements being compliant with the manufacturer's instructions and all applicable local regulations.

Warranty Conditions

Upon delivery, the product packaging should be inspected for transit damage and opened to check that the product and accessories are complete and in good condition. Claims for transit damage or missing parts will not be considered unless made within 3 working days of delivery, with supporting images and documentation provided.

Warranty Scope

The Charge-M8 Omega DC Charger range includes Bronze on-site parts and labour engineer support (10-day SLA) for the warranty period, which can be upgraded to Silver (5-day SLA) or Gold (48-hour SLA), subject to application and payment of the applicable upgrade rate within 28 days of installation. Please contact Support for further information.

During the warranty period, Charge-M8 may replace or repair components or the whole unit at our discretion, based upon assessment by our appointed engineers. Warranty on replacement parts and components expires in line with the original warranty period.

Technical support can be obtained by contacting the customer team at **sales@charge-m8.com** or calling **+44 333 242 3328**.

Charge-M8 Ltd.
Mirwell Business Centre
Carrington Lane
Sale
Cheshire
M33 5NL