



Office for
Low Emission
Vehicles

Approved Product



Charge-M8[®]



BUILT-IN EARTH PEN PROTECTION

DELTA Home & Office Fast AC Smart Charger

Installation & Operating Instructions



WARNING: High Voltage Appliance

This unit **MUST** only be fitted by a qualified installer in compliance with electrical regulations. Units fitted incorrectly and/or by unqualified installers will invalidate the manufacturer's warranty.



Important Notes:

Thank you for purchasing a Charge-m8® Delta EV charger.

Please read the installation and operating instructions carefully, to ensure correct installation and configuration, and a trouble-free user experience.

This charger must be installed in compliance with BS EN 61851, IET Wiring Regulations (BS 7671); the recommendations of the IET Code of Practice for Electric Vehicle Charging Equipment Installations (as amended); Electricity Safety, Quality and Continuity Regulations, Building Regulations Part P and all other applicable standards.

The charger is a complex electrical device, not intended for end-user or installer service or maintenance. The unit should only be opened by a qualified Charge-m8® engineer, the opening of the unit by any other person will invalidate the manufacturer's warranty.

This manual is intended as a guide, and all reasonable effort has been made to ensure the accuracy of the information contained herein at the time of publishing. At all times installers should reference their local electrical regulations, in particular guidance on the installation of EV charging equipment and qualifications required.

Once installed, be sure to register your charger with us, to ensure prompt after-sales service and activation of the full suite of accessible Charge-m8® APP features.

If you have any queries regarding Charge-m8® charging equipment, please contact us.



Contents

1. Introduction	3
a. Product Appearance	3
b. Product Type	4
c. Emergency Stop	5
d. Technical Details	5
e. Box Contents	6
f. Storage, Transportation & Recycling	6
2. Installation	7
a. Before You Start	7
b. Safety Notice	8
c. EarthProtection	8
d. Installation Guide	9
i. Standard Wall Fixing	9
ii. Optional Pedestal Mount	9
iii. Supply Connection	9
e. Connection To WiFi	10
f. Connection To Ethernet(RJ45)	10
g. Connection To 4G(Mobile)	10
h. Connection to OCPP 1.6 Web Socket (Optional service)	11
3. Operation	12
a. Preparing To Charge	12
b. Charge options	13
c. Charge Completion	13



1. Introduction

a. Product Appearance

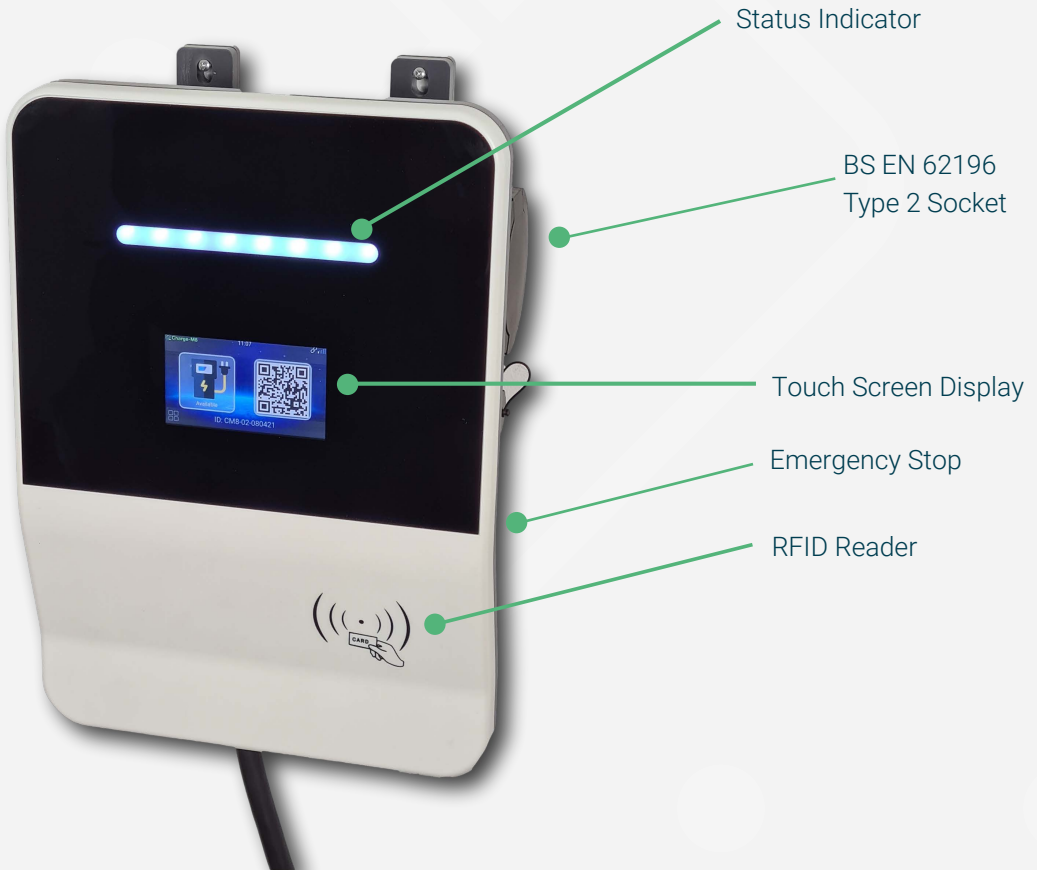



b. Product Type

The Charge-m8® Delta Home & Office EV Charger is designed exclusively for use as a charger for Electric and Hybrid Electric Vehicles and confirms to BS EN 61851 with a BS EN 62196 Type 2 socket.

Any electric (EV) or hybrid (PHEV) vehicle that can accept an AC charge of up to 7.3KW via a lead connected to a BS EN 62196 Type 2 socket can be charged with the appropriate cable. The vehicle user will require a suitable charging cable to connect to the charger.

The Charge-m8® Delta is a Mode 3 Smart charger that is available with multiple network connection options, including WIFI, RJ45 Ethernet and 4G Mobile.

Standard specification includes OCPP 1.6 Web Socket connectivity, pre-configured to the Charge-m8 APP, making it suitable a wide variety of private, semi-public and public applications. Charging data, including duration, current, cost and capacity is available to both the user, and site owners through advanced reporting.

Users can operate the charger with an RFID card or APP. In Semi-Public & Public applications, electricity usage can be charged through the APP and reimbursed to the charging station site owner.

Different groups of drivers can be assigned to different pricing plans, for example a company with publicly accessible car-parking may wish to provide free or subsidised charging to their employees, but also allow the public, guests and visitors access to charge for a fee via credit/debit card charge either through the Charge-m8® APP or by scanning the fast QR Code displayed on the touch screen.



c. Emergency Stop



If required, the charger unit can be stopped by pressing the emergency stop button on the bottom right-hand side of the unit.

The unit can be reset by rotating the depressed emergency stop button clockwise until it clicks back into its normal position.

d. Technical Details

Rated Voltage	230v/AC ±10% - 1Phase, 400v/AC ±10% - 3Phase
Maximum Output	7.3KW 32A - Single Phase, 22KW 32A - Three Phase
Operating Frequency	50/60HZ
Screen	4.3" Touch Screen
RFID Card	ISO 14443A, MIFARE DESFire EV1
Standby Power Consumption	6W
Communication Modes	WIFI / RJ45 / 2G, 3G, 4G / OCPP 1.6 / RFID / APP
IP Protection Level	IP65
Operating Temperature	-25°C to 55°C
Energy Meter	EU MID Approved Energy meter
EMS	EN6100-4-5 ±2KV/±4KV
EMI	CISPR22 / EN 55022 Class B
Standards	CE - EN61851-1 BS EN 62196 Mode3
Dimensions and Weight	300w x 150d x 410h (mm) 8KG



e. Box Contents

1. Delta 7.3KW AC EV Charger
2. Wall Fixing Bolts
3. RFID Card (x3)
4. Installation & Operating Manual

The Delta charger must be protected by a Class A RCBO 2P-40A 30mA (not supplied).

f. Storage, Transportation & Recycling

The Delta charger packaging is designed for transit, however as with any electrical appliance, care should be taken to avoid excessive handling and potential damage to the charger case or internal components.

Care should be taken whilst unpacking the Delta charger to ensure all components are present, and no damage is visible to the unit.

Packaging should be recycled where facilities exist.

End of life chargers should be disposed of in compliance with The Waste Electrical and Electronic Equipment (WEEE) Regulations (2013)

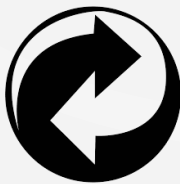
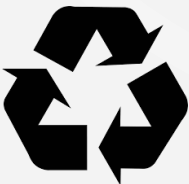



2. Installation

a. Before You Start

Check the proposed location for the installation complies with Building Regulations Part P, the Delta charger must be installed in compliance with BS EN 61851, IET Wiring Regulations (BS 7671); the recommendations of the IET Code of Practice for Electric Vehicle Charging Equipment Installations (as amended); Electricity Safety, Quality and Continuity Regulations, and all other applicable standards.

If not being installed by a Charge-m8® engineer, the installer must be suitably qualified and hold verifiable certification for the installation of EV charging equipment, and be authorised by Charge-m8 as an approved installer.

A suitable Class A RCBO 2P-40A 30mA (not supplied) of the correct type and model to fit in compliance with the existing electrical supply equipment, must be installed to protect the Delta charger (not supplied).

The earth must be checked and verified before power on. (*Ref: c. Earth Protection*)

Ensure that all appropriate tools used during the installation have been insulated/grounded to prevent accidental short circuit or personal injury.

Under no circumstances should the Charge-m8® Delta EV charger be opened, amended or have any parts connected to it without the manufacturers consent. To do so will invalidate the manufacturer's warranty.



b. Safety Notice

EV charging equipment contains high voltage current, care must be taken to ensure your personal safety. Always follow the manufacturers operating instructions.

Children must not be allowed to use the charger.

Observe the charger status indicators and contact Charge-m8® after-sales support for assistance if the unit displays fault warnings and/or fails to operate correctly.

Avoid unnecessarily disconnecting the power supply when the charger is running normally.

c. Earth Protection

The Charge-m8® Delta EV Charger includes built-in PEN fault sensing that protects against the loss of earthing.

An integrated circuit constantly monitors the earth and neutral and immediately places the charger into its fault mode in the event of a fault/potential fault, disconnecting the Live, Neutral & Earth from the vehicle.

In compliance with Amendment 1:2020 of the 18th Edition, Charge-m8® chargers with integrated earth protection do not require the installation of additional earth rods or transformers and ensure safe operation when connected to common PME (Protective Multiple Earth) systems.

If the system has detected an issue and enters in to its fault mode, the charger must be manually reset through being isolated at source for a minimum 30 seconds and rebooted, upon which it will complete an initialisation and self-check procedure. If the charger immediately re-enters its fault mode once rebooted, the installation will require further investigation to determine the cause of the fault.



d. Installation Guide

i. Standard Wall Fixing

The Delta Charger should be fixed to a suitable wall, sufficient in strength to support the weight and operational use exerted on the Delta charger, using the fixing bolts provided or other suitable fixings if required.

Care should be taken to site the Delta charger away from excessive rainfall or water sources.

ii. Optional Pedestal Mount

An optional pedestal mount is available where required.

A suitable base must be provided (not supplied)



iii. Supply Connection

The pre-crimped connection lead should not be replaced, and must be connected to the supply using a suitable IP rated junction box (not supplied).



e. Connection To WiFi - Standard Specification

Your Charge-m8® installation engineer will connect your charging unit to your WIFI network for you.

If your Wi-Fi SSID or password changes, please contact customer support who will guide you through the process of updating your charger network settings.

f. Connection To Ethernet (RJ45) - Optional service

If you specify the optional Ethernet network connectivity, a one metre tail of RJ45/Cat5 cable will be provided from the Delta Charger.

Your Charge-m8® installation engineer will connect your charging unit to a suitably located RJ45 socket for you.

g. Connection To 4G - Optional Service

If you specify the optional 4G network connectivity, a 4G communications module and pre-configured SIM card will be provided and pre-installed within the Delta Charger.

4G connectivity is an optional service and requires an active Charge-m8 subscription. Charge-m8 4G connectivity is backwards compatible with 3G & 2G, and uses non-steered SIM technology to automatically lock onto the strongest signal from any of the major UK networks to ensure the best possible connection.

Your Charge-m8® installation engineer will check the 4G connection when commissioning your Delta charging unit.



h. Connection to OCPP 1.6 Web Socket (Optional service)

Your Charge-m8® Delta Charger is supplied pre-configured to connect to the Charge-m8 OCPP 1.6 websocket/server. Provided you have a valid subscription, once your charger has established a network connection it will connect automatically.

When connected to our network you can take advantage of the following features:

- Connect your charger to our public network and allow others to use your charger for a fee (for example when drive sharing, installations in office car parks or public places).
- Access our pan-European network of charging points using the Charge-m8 APP, and pay for each charge easily with your saved credit/debit card.
- Allows Charge-m8 engineers to remotely update the software on your Delta charger, and where necessary investigate any faults reported quickly, without having to wait for a site visit by an engineer.



3. Operation

a. Preparing To Charge

- a) Ensure that the Delta charger is on, and the touch screen shows ready to charge (available).
- b) Connect your charging cable to the charger, and then to your vehicle. The LCD display will now show waiting for vehicle.

If your Charge-m8 engineer has configured your Delta charger to allow 'Plug & Charge' capability (for instance on your own private drive), ignore 'c)' below and go directly to 'd)'.

- c) Use your chosen method of charge activation:
 - a. RFID card – pass your card over the RFID reader to start charging.
 - b. APP – open the APP, connect to the charger and press 'Start'.
 - c. QR Code – guests and visitors can scan the QR code to visit a one page charge screen and follow the instructions.
- d) Check that the LCD display and indicator light confirms charging is in progress. It will display the charge duration, power & KWH used.

e) Status Indicator Light:

- | | |
|-------------------------------|---------------------|
| a. Standby/Available: | Steady white light |
| b. Plug in - ready to charge: | Steady purple |
| c. Charging in progress: | Blinking blue light |
| d. Charging completed: | Steady green light |
| e. Alarm/Fault: | Steady red light |



b. Charge Options - Press the charger icon to access the menu

- Full Charge - Default setting, charger will charge until the battery is full.
- Energy Limit (KWH) - You can select a maximum KWH to use. Once the charger reaches this limit charging will stop.
- Time Limit (HH:MM) - You can select the exact amount of time in hours and minutes to charge. Once the charger reaches this limit charging will stop.
- Time Delay (HH:MM) - You can set a time to commence charging using the 'Timing' function, useful if you want to take advantage of cheaper overnight electricity rates. A countdown to charge is shown on the touch screen.

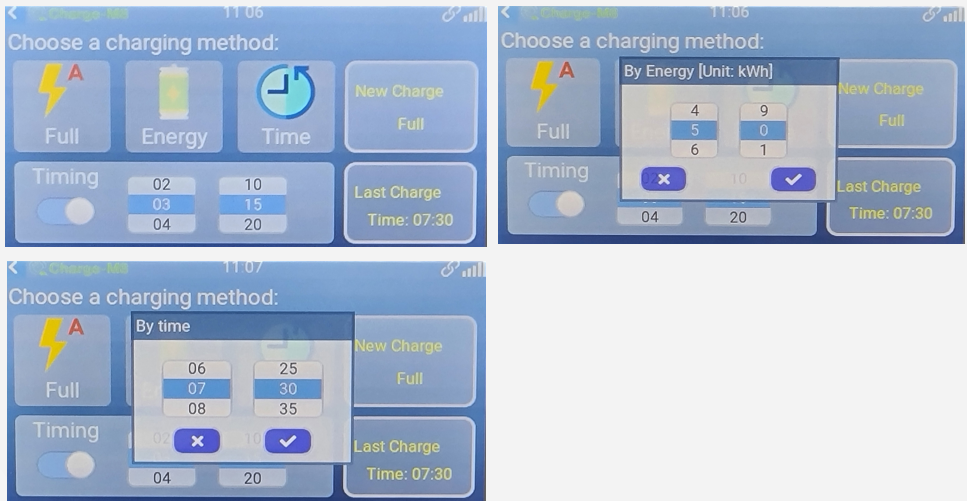

b. Charge Completion

- RFID card – pass your card over the RFID reader to stop charging. Wait for the display to confirm before removing the charge connector from your vehicle.
- APP – open the APP, connect to the charger and press 'Stop'.
- The charger will settle the charge transaction and display the charge session data on the screen until the plug is removed from the socket.



i. Maintenance

Your Delta charger should be checked regularly for any obvious signs of damage and the RCBO (circuit breaker) tested to ensure safe operation.

If you are in any doubt or have cause for concern you should immediately press the emergency stop button and contact Charge-m8® Customer Service for advice.

ii. How do I download the Charge-m8 APP?

The Charge-m8 APP is available for download from both the Google Play Store and Apple AppStore:

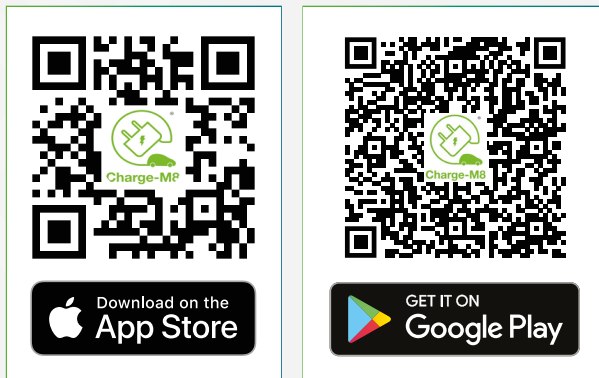

iii. How do I configure the Charge-m8 APP?

Once you've downloaded and installed the correct APP for your device, just register your account via the APP to use publicly accessible Charge-m8 EV Points as a Guest. To configure the APP to control your private home Charge-m8 point, just call customer services and we'll set this up for you!



Installation Record

Installation Date:

Engineer Name:

Serial Number:

Notes:



Charge-M8[®]



*Follow us on social media
/chargem8*